

Fire Rating 2 Hours (SS-3)

Description

Frame : JayaBMS Track, JayaBMS Deflection Head Track, JayaBMS Stud

Lining : 2 layers of USG Boral Firestop 13mm (both sides)

Weight : $\pm 43 \text{ kg/m}^2$

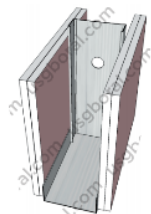

STUD SIZE (mm)		MAXIMUM HEIGHT (mm) Non-Load Bearing Studs			WALL THICKNESS (mm)	FIRE RATING (minutes)	ACOUSTIC RATING (STC)	
Width	Thickness	@600mm centres	@400mm centres	Grade BS 5234			Without Insulation	Insulation Mineral Wool 50mm
64	0.5	4050	4250	Severe Duty	116	120	46	56
	0.7	4200	4500			120		
76	0.5	4650	4950		128	120	47	56
	0.7	4900	5250			120		
92	0.5	5550	6000		144	120	48	57
	0.7	5900	6250			120		
100	0.5	6050	6300		152	120	48	57
	0.7	6250	6600			120		
150	0.7	7850	8600		202	120	50	57